

305 MARATHON COURT, COQUITLAM, BC

LOWER FLOOR TOTAL: 53 SQ.FT.
 MAIN FLOOR TOTAL: 898 SQ.FT.
TOTAL: 951 SQ.FT.
 ATTIC: 348 SQ.FT.
 BALCONY: 102 SQ. FT.

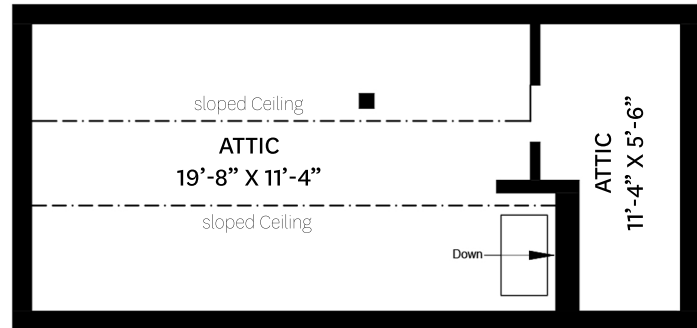
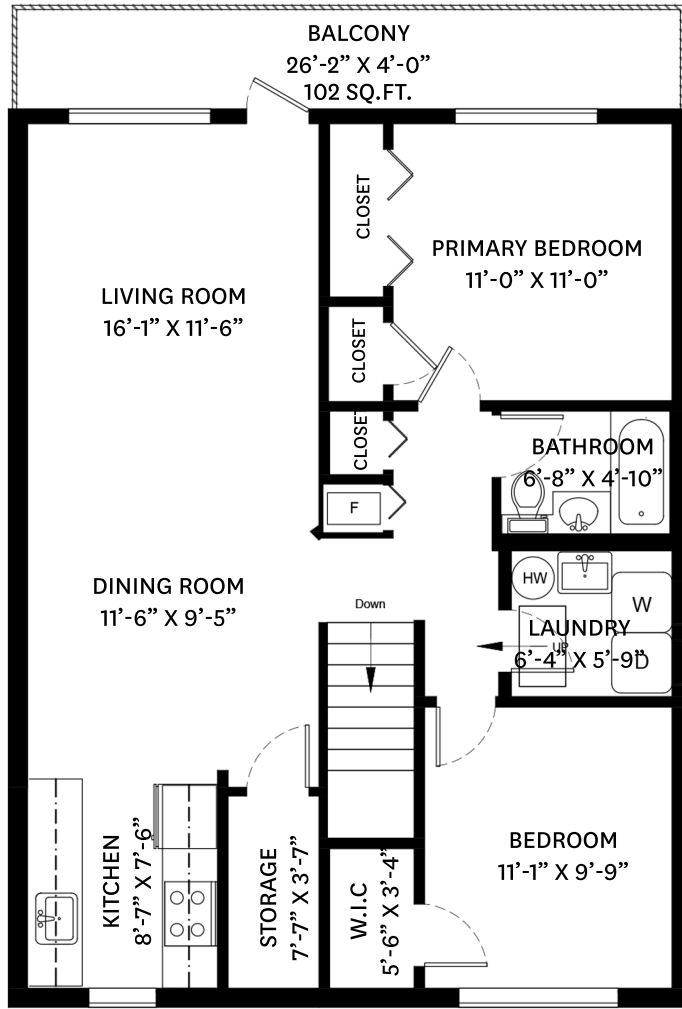

ATTIC FLOOR PLAN
Ceiling Height: 5'-5"

LOWER FLOOR PLAN
Ceiling Height: 8'-0"

MAIN FLOOR PLAN
Ceiling Height: 8'-10"

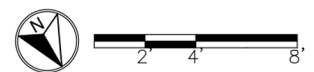

Corey Zach PREC*
604.551.8547

WestCoast Realty™ corey@coreyzach.com

floor plan designed by
ishot.ca Enterprises Inc.
604-368-7979
<http://ishot.ca>

*PERSONAL REAL ESTATE CORPORATION. THE FLOOR PLAN ILLUSTRATION IS NOT SUITABLE FOR CONSTRUCTION/ARCHITECTURAL PURPOSES. MEASUREMENTS ARE APPROXIMATE AND MAY NOT BE TO SCALE. E&O INSURED.